

News on the Nineteenth

WITH *God*
ALL THINGS ARE
possible

Wormley C of E Primary School (VC)
Cozens Lane East, Wormley, Broxbourne, Herts, EN106QA

Tel: 01992 303331

Have Faith, Show Respect, Take Responsibility and Achieve

www.wormleyprimary.co.uk

July 2025



FAREWELL

It is always sad at the end of the year to say farewell to our Y6 pupils and staff moving on.

We had a **Year 6 Leavers Service** on Thursday morning to celebrate all that our pupils have become and all that they have achieved. They are our most academically successful year group for a few years.

In addition to all the subjects they have studied, we hope that they have learnt many characteristics to help them in their lives - *consideration, resilience, confidence, creativity, strategy, curiosity, reflection and wellbeing.*

We hope they will remember to deploy their agents when they need them! They have learnt about *community* and the *joy of friendship* - we hope they continue to contribute to new communities throughout their lives and treasure the friendships they make along the way.

By attending a Church of England school, we make no excuses for introducing God into the lives of our children. We hope that they know that they are *loved*, that they are never alone and that *'with God, all things are possible.'*

During times of great joy or times of great challenge, they will have a special friend they can rely upon - a light which will guide them and bring them hope.

We also say goodbye to some very dear members of staff, some of whom have dedicated years of their lives teaching here.

Mrs Plester has been teaching in Y5 this year. She has been a teacher at this school for 13 years. It will not feel the same without her but we wish her well as she moves to work in a village school where her children attend.

Mrs Johnson has been teaching in Y3 this year. She has been a teacher here for 3 years. She is leaving teaching to try a different career in massage and wellbeing therapies. We wish her happiness. She will be back for Messy Church!

Ms Isik has been an Early Years Practitioner in our Early Years Team. She is also leaving education but you might catch a glimpse of her in a nearby, well known shop. We thank her for her care of our youngest pupils.

They have shown such great commitment, dedication and love in their roles here at Wormley CofE Primary School and I know you will join me in wishing them joy and satisfaction in their new roles.

GOOD LUCK

We will all miss them and thank them for their loyal service to our school.

We welcome new members of staff to our school. **Mrs Ciccarelli** will be teaching in Y6, **Miss Currie** in Y5 and **Miss Conway** in Y2.



RETURN TO SCHOOL

Please see information regarding the return to school on **Thursday 4th September**.

Entrance	Location of gate	Year Group
Entrance A	Front gate	Y2
Entrance B	Gate to KS1 playground	YR, Y1
Entrance C	Gate next to Preschool	Preschool, YN
Entrance D	Back gate	Y3, Y4, Y5, Y6

Children should arrive promptly, in their school uniform, with the appropriate equipment.

Beginning and end of the day

There will still be a *soft start* at the start of the day to allow for parents to drop children at the different entrances.

Please arrive from **8:45**. **Gates will be locked at 8:55am**.

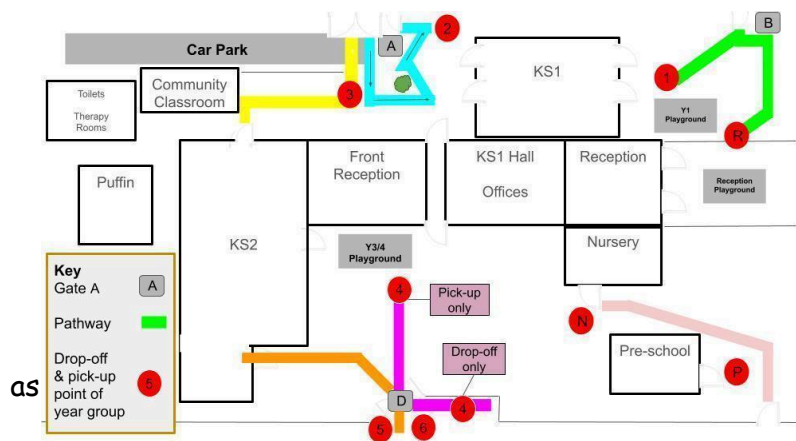

Once in school, children will settle to a learning task.

At the end of the day, parents will collect their children from the same entrance as the one they dropped them to.

Morning registers will close at **8:55am**. After this point your child will be marked late - this is the same as an unauthorised absence.

Attendance

Attendance is compulsory if children are well. If children are not well enough to attend, it is essential that parents make the school aware of the reason for any pupil absence before the start of the day by emailing attendance@wormleyprimary.co.uk. If parents do not let us know why their child is absent, a member of the school admin team will have to phone the family of every child who is not in school. This forms part of our safeguarding practices.

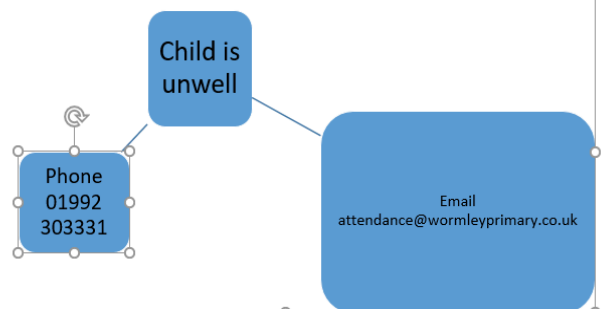

Uniform

We expect all children to be dressed in school uniform. Please check the school website if you need to clarify what children should wear for school and for PE. We have a pre-loved uniform shop. Each item is sold for 50p. We do not insist on school logos on uniform.

PE kits should be worn all day on the day children have PE.

Jewellery should not be worn to school.

Haircuts should be appropriate for school and long hair tied back.

Payments via Arbor

Payments for school meals, Breakfast and After School Club (BASC), resources etc. should continue to be made via online payments using Arbor.



Healthy Home Packed Lunches and Water Bottles

A reminder that home packed lunches must be healthy and meet all nutritional expectations for meals consumed in school. Water bottles - marked with children's names - are essential please.



Breakfast and After School Club (BASC)

Breakfast and After School Club can be booked via Arbor, in the coming weeks for the Autumn Term.

Trips, Visits and Visitors

We have already booked history workshops and visits for the Autumn Term.

Please check the website for dates in the school calendar for 2025-2026

We will also be using the local environment for local History and Geography studies.



Home Learning and Remote Learning

For setting home learning and sharing information with parents, we use **Tapestry** for Preschool, YN and YR and the **Google Classroom** for Y1- Y6. Please ensure you have access to these platforms in the Autumn Term. They have been set up already for you to access.



Google Classroom



WORMLEY'S SUMMER CONCERT AND FAYRE

We hope you all enjoyed our Summer Concert.



The children certainly deployed their Agent Confident and Agent Creative!

They really enjoyed performing to you, despite the sun and the rain! We were very proud of them all - rock groups, dancers, drummers, ukulele players and soloists!

A big **THANK YOU** to our PTA for organising the stalls and activities after.



A lot of fun was had - at the football tournament, hooking a duck, lucky dip, throwing 'poo in the loo', beating the goalie, drumming or munching hot dogs and burgers!
The school team did well with the bar-be-que and kept everyone fed!

We raised about £1200 which we hope will go towards our History workshops and trips.

WELCOME TO ALL NEW NURSERY AND RECEPTION FAMILIES

We send a warm welcome to our new families who will start with us in September.

We look forward to seeing you on your visit dates - **Thursday 4th and Friday 5th September.**

Reception children come for their first morning on **Monday 8th and Tuesday 9th September** until 11:45 am and then stay for lunch on **Wednesday 10th and Thursday 11th September** until 13:10 pm.

They will be in school full-time from **Friday 12th September (8:45-3:15).**



IMPORTANT DATES

Thursday 4th September

Return to school

Monday 28th October

HALF TERM WEEK

Monday 3rd November

INSET Day

Tuesday 4th November

Return to school

Friday 19th December

Break up for Christmas 1:20pm

Monday 5th January

INSET DAY

Tuesday 6th January

Return to school



SHAKESPEARE ROCKS! OUR Y6 PRODUCTION

Our Y6 children performed a very funny play about William Shakespeare

The performance was greatly enjoyed by all the children and their families.



OUR VALUE NEXT HALF TERM IS RESILIENCE

Next half term we will be learning about the value of **RESILIENCE** - determination, courage, overcoming difficulties, perseverance, grit and bouncebackability!

We will be reading about some great superheroes and superheroines from the Bible who demonstrated great resilience.

"We are afflicted in every way, but not crushed; perplexed, but not driven to despair; persecuted, but not forsaken; struck down, but not destroyed." 2 Corinthians 4:8-9



LONDON ROCKS

Thank you to KS2 teachers and children for taking part in this year's times table competition.

We scored an amazing number of points (correct answers).

The top scoring class of our school was **Whales**.



The top scoring pupil was **Mehmet**.

Mehmet also came 17th in the competition!.



Week of Inspirational Maths

Our children will have an exciting start to next term with a 'week of inspirational maths'. There will be a geometry focus. They will watch videos and take part in a range of practical activities inspired by [youcubed.org](https://www.youcubed.org) which will provide them with an opportunity to build their maths confidence and their maths resilience in a fun, positive and creative way.

ST AUGUSTINE'S CHURCH FAYRE

On Saturday 12th July, Wormley CofE Primary School choir sang at St Augustine's church fayre.

They all turned out - in the heat - to entertain us with four wonderful songs.

A big THANK YOU to our pupils and their lovely families!



REMINDER - ABSENCE FOR HOLIDAYS

We have over 100 children who have attended school every day this term which is a massive increase. Their 100% badges will be delivered to the classrooms to be given out.

We have 20 children who have attended school every day this year! Plus an additional 6 who have only missed a half day for an unavoidable hospital appointment. There is a celebration with them on Thursday.

Any absences for holidays in term time will not be authorised and could result in a penalty notice being issued.

All planned absence should be requested at least 2 weeks in advance giving clear reasons, with supporting evidence, as to why absence is unavoidable. Please note dates for the coming year and book holidays outside of term time.

IMPORTANT DATES

TERM/HOLIDAY	FIRST DAY	LAST DAY
INSET day	3rd September 2025	
Autumn term	4th September 2025	19 th December 2025 1:20pm finish
Autumn half term holiday	28 th October 2025	31st October 2025
INSET day	3rd November 2025	
Christmas break	22 rd December 2025	2 rd January 2026
INSET day	5 th January 2026	
Spring term	6 th January 2026	27th March 2026 1:20pm finish
Spring half term holiday	16 th February 2026	20 th February 2026
Easter break	30th March 2026	10th April 2026
INSET day	13th April 2026	
Summer term	14th April 2026	22nd July 2026 1:20pm finish
May bank holiday	4 th May 2026	
Summer half term holiday	25 th May 2026	29 th May 2026
Summer break	22nd July 2026	2nd September 2026



Y3 VISIT FRAMELESS ART GALLERY

Y3 children had a most wonderful day at Frameless on 24th June. The experience was quite mind blowing as we became part of many famous paintings! See what you recognise

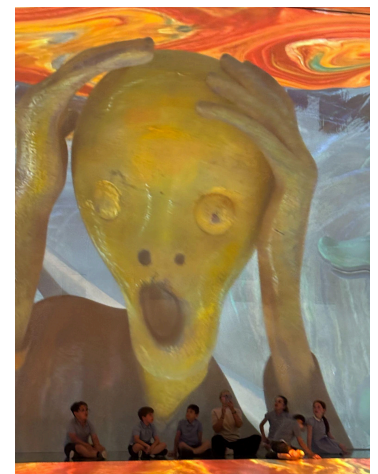

VOLUNTEERS NEEDED

If you have a spare afternoon and would like to help out in school, such as listening to children read, we are looking for volunteers.

Please let us know if you are interested.



ROCK ON WITH ROCK STEADY LESSONS IN SCHOOL

It's a delight to share that Rocksteady lessons are continuing in our school next year.

We hope you enjoyed the performances at our concert!

Learn to play in a band

Learning an instrument should be fun. Your child can choose from the electric guitar, keyboard, drums or vocals and enjoy playing in a happy, supportive environment with their friends.

Led by real musicians

Your child's music teacher should also be their role model. Which is why all Rocksteady Band Leaders are carefully chosen, extensively trained musicians who know how to inspire a life-long love of playing music.

In school time

Lessons are 30 minutes long and take place in school time with all instruments provided, making it hassle-free for parents.

With regular live performances

Playing on stage is a huge confidence booster. With termly concerts at school assemblies, your child will be able to show off their progress to friends, teachers and parents with the rest of their band.

And happily affordable

Rocksteady is one of the most hassle-free ways to learn an instrument on a rolling subscription that you can cancel at any time. It's risk free too - cancel in the first month and you'll get a full refund.



Email: info@rocksteadymusicschool.com Call: 0330 113 0330 (Calls are charged at local rate)

RETURN TO SCHOOL

There is an INSET day on **Wednesday 3rd September.**

The new school term begins on **Thursday 4th September.**

Nursery and Reception children will be sent their own starting dates.

END OF TERM

Term finishes on **Friday 18th July at 1:20pm**



WISHING YOU ALL A VERY HAPPY SUMMER BREAK

We wish you all a safe and happy summer holiday.

Please keep the children reading and practising their tables, activities and enjoying playing outdoors.

See you all in September.

God Bless.

"Jesus Christ is the same yesterday and today and forever." Hebrews 13:8

TOOLBOX FOR CHILDREN WITH ADHD AND AUTISM

With the school holidays just around the corner, we wanted to highlight two valuable resources designed to support children and young people with autism, ADHD, or those awaiting a diagnosis: the **Toolbox Live Chat** and the **Cogs** app. The Toolbox Live Chat, available at www.thetoolbox.mindler.co.uk offers a safe and supportive environment for young individuals to discuss their feelings and concerns with a live person.

The **Toolbox Live Chat** can be used to talk about:

Feelings and emotions

Understanding Autism/ADHD

Building and maintaining relationships

Available services and resources in Hertfordshire

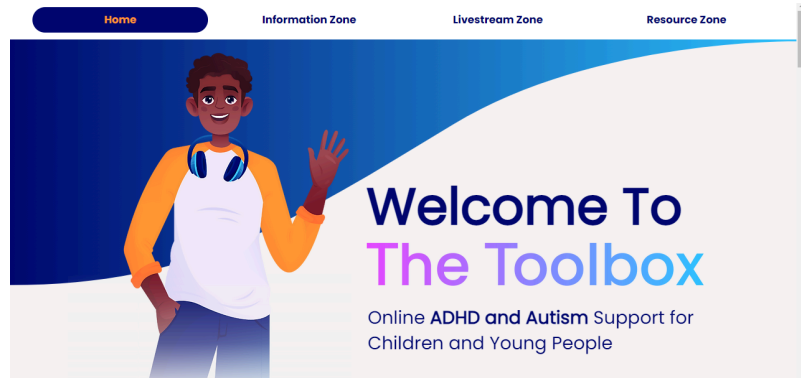

The **Cogs** app serves as a personal mental well-being coach, helping CYP to manage challenging situations and develop positive habits.

Both of these resources can be incredibly beneficial for children and young people who need someone to talk to about their experiences and challenges. Please feel free to share this information with anyone who might benefit from this support.

For more details on both, you can visit The Toolbox.

IF HOME ISN'T SAFE SEEK HELP

No one should suffer abuse from another person. No child should witness abuse of a parent.

If you, or someone you know, is experiencing domestic abuse, call

0300 7906772 for advice and support.

In an emergency, always call **999**.

If you are afraid to speak, call **999** from a mobile and press **5,5**.

For more information, go to hertssunflower.org

This number operates 9am to 5pm, Monday to Friday.
Calls outside of these hours may be diverted to a national helpdesk.



BOOK
NOW



EMPIRE

BOOK
NOW

SEMH SPECIFIC

HAF

SUMMER CAMP

28 JUL -
1 AUG
2025

9AM-1PM
AGE 5 - 12

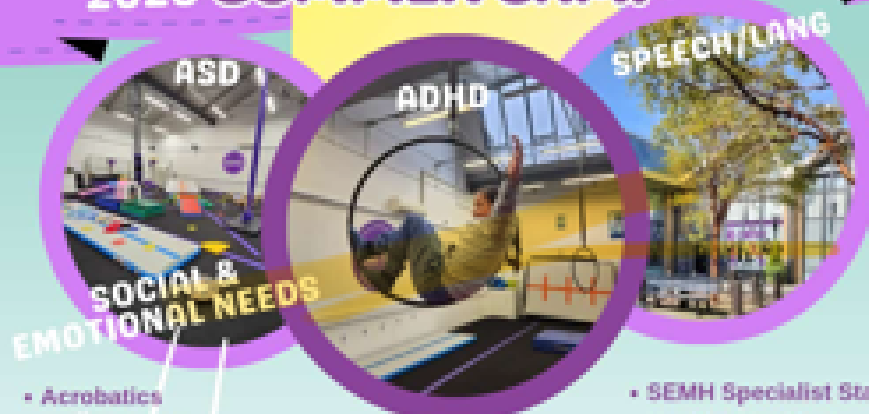

- Acrobatics
- Flips & Tricks
- Aerial & Circus

- Ninja Courses
- Sensory & Regulation Zones
- Crafts & Block Building

- SEMH Specialist Staff
- Healthy Hot Meal
- Snack Stations

Esp-studios.co.uk

Empire Performance Studios,
Unit 24-26 Island Centre Way, EN3 6GS

07950077659